

CEDAR RAPIDS, IOWA



Model: 15000 & 15002

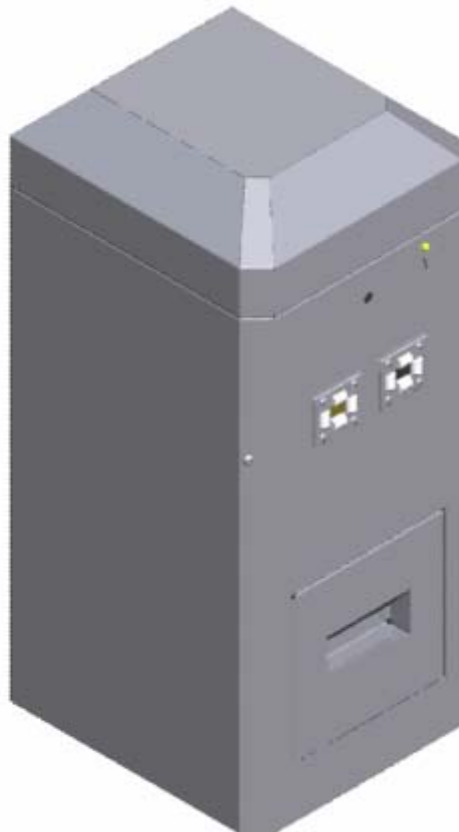

Table of contents:

Page 2.....	Table Of Contents
Page 3.....	Specifications
Page 3 & 4.....	Installation
Page 5.....	Maintenance
Page 5 & 6.....	Troubleshooting
Page 7 – 11.....	Part Drawings
Page 12.....	Wire Diagram

Specifications:

- Unit requires 110VAC, 60hz – 20 AMP service
- 110VAC, 60 HZ Thomas compressor, ¾ HP- 11.1A, Thermally protected
- SOLENOID, 110V N.C. 1/8" ORF. 1/4"NPT
- 110VAC, 50-60 HZ Vend 2000 Infitec timer
- Unit intended for outdoor and commercial use only
- Weight: 230 Pounds
- Height: 42 ¾"
- Width: 18"
- Depth: 20"

Installation:

- Determine location to mount unit
- **("DANGER" "THIS EQUIPMENT INCORPORATES PARTS SUCH AS SWITCHES, MOTORS, OR THE LIKE THAT TEND TO PRODUCE ARCS OR SPARKS THAT CAN CAUSE AN EXPLOSION. WHEN LOCATED IN GASOLINE-DISPENSING AND SERVICE STATIONS INSTALL AND USE AT LEAST 20 FEET (6 M) HORIZONTALLY FROM THE EXTERIOR ENCLOSURE OF ANY DISPENSING PUMP AND AT LEAST 18 INCHES (450 MM) ABOVE A DRIVEWAY OR GROUND LEVEL."**
- Unit to be supplied with 110VAC, 20AMP service. Make sure adequate wire service is supplied to unit, under sizing wire may result in damage to compressor and/ or machine malfunction (fire hazard).
- Unit to be installed by a qualified electrician.
- **Grounding Instructions:** This appliance must be connected to a grounded metal, permanent wiring system; or an equipment-grounding conductor must be run with the circuit conductors and connected to the equipment-grounding terminal or lead on the appliance.
- Mount pattern for unit is shown in Fig 1.
- Conduit for electrical can be stubbed up thru bottom of machine or stubbed to knockout located in the lower rear of machine.
- Wiring is to taken up to timer assembly located in the top of unit.

Fig. 1

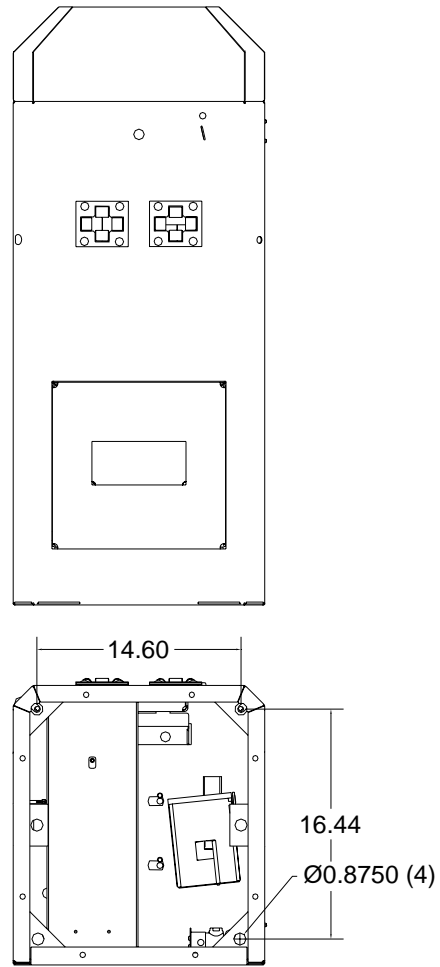

Operation:

- Insert quarter(s)
- Select function to be used.

- If air is selected, attach chuck to valve stem a squeeze tire chuck handle to inflate. Inflate tires only to manufactures specifications.
- If water is selected, squeeze handle to activate.
- When finished, slowly walk hose back to machine and allow hose to coil up on retractable reel.

Maintenance:

- Clean cabinet weekly with stainless steel cleaner and non-abrasive cloth.
- Check air hose for cracks or excessive wear.
- Check water hose for cracks or excessive wear.

Trouble shooting:

STARTS BUT NO PRESSURE	SYSTEM LEAKING	CHECK AIR HOSE FOR LEAKS AND AIR CHUCK. ALSO CHECK FOR LEAKS AROUND COMPRESSOR.
	CHUCK IS CLOGGED	CHECK AIR CHUCK TO MAKE SURE NO DEBRIS IS AIR PATH. ALSO CHECK O-RING AROUND AIR CHUCK, TO SEE IF IT IS BLOCKING AIR PATH
	UNLOADER	IFF UNLOADER IS NOT WORKING PROPERLY REPLACE
	PARTS DAMAGED OR WORN OUT.	SLEEVE IN COMPRESSOR MAY BE PITTED OR SCRATCHED UP. PISTON O-RING MAY BE WORN OR DAMAGED. DEBRIS IN VALVE PLATE OPENING IS NOT ALLOWING IT TO SHUT. REPAIR KIT MAY BE NEEDED.
UNIT WON'T START	TIMER NOT SET	SET TIMER FOR KNOWN AMOUNT.
	NO POWER TO UNIT <div style="border: 1px solid black; padding: 2px; display: inline-block;"><CAUTION ></div>	CHECK TO SEE IF POWER IS ON CHECK TO SEE IF BREAKER IS TRIPPED
	WIRED INCORRECTLY	CHECK AGAINST WIRE DIAGRAM.
	WIRING IS LOOSE	POWER OFF, CHECK SCREW TERMINALS, & WIRE NUTS, POWER ON.

	<p>MOTOR FAULTY</p> <p>TIMER FAULTY</p> <div style="border: 1px solid black; padding: 5px; width: fit-content; margin: 10px auto;"> <p>< CAUTION ></p> </div> <p>MICROSWITCH FAULTY</p>	<p>IF THE MOTOR DOES NOT RUN, DEPRESS TRIGGER ON INFLATOR. IF MOTOR STILL DOES NOT RUN, TURN POWER OFF, REMOVE UNLOADER AND TRY TO RUN WITHOUT IT. IF MOTOR RUNS THE UNLOADER IS THE PROBLEM, BUT IF IT DOES NOT THE MOTOR IS BAD.</p> <p>CLOSE MICROSWITCH OR PUSHBUTTON REQUIRED NUMBER OF TIMES TO START TIMER. CHECK VOLTAGE ACROSS TERMINALS 8 & 10 OF INFITEC TIMER AS IT IS TIMING. IF THERE IS NONE, THEN TRIP TIMER WITH AN INSULATED JUMPER WIRE STRIPPED ON BOTH ENDS. IF TIMER STILL DOES NOT COME ON IT IS FAULTY.</p> <p>TRIP SWITCH MANUALLY BY PUSHING DOWN WIRE ON SWITCH. IF TIMER DOES NOT ACTIVATE USE INSULATED JUMPER WIRE AS ABOVE TO ACTIVATE TIMER. IF TIMER COMES ON THE MIRCOSWITCH IS BAD.</p>
--	--	--

REV
15001-10A

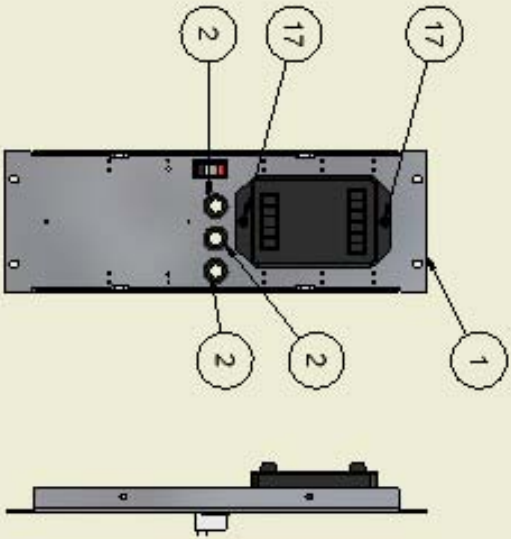

BILL OF MATERIALS

ITEM	PART NUM	DESCRIPTION	QTY
1	15001-10W	TIMER CONTROL WELDMENT	1
2	5639D4	RUBBER GROMMET	3
3	5900D3	YELLOW PUSH ON	2
4	5900D5	PUSH ON CONNECTOR	4
5	5901D1	YELLOW WIRE NUT	4
6	5904D3	TERMINAL JUMPER	1
7	5906D1	RED BUTT CONNECTOR	7
8	5906D2	BLUE BUTT CONNECTOR	3
9	5914	SWITCH, SPST ROCKER 20A	1
10	5943B3229	18 GA WHITE WIRE	57"
11	5943B3220	18 GA BLACK WIRE	203"
12	5943B3226	18 GA BLUE WIRE	88"
13	5943E3220	12 GA BLACK WIRE	51"
14	5943E3225	12 GA GREEN WIRE	22"
15	5943E3229	12 GA WHITE WIRE	31"
16	8113	BLUE FORK	8
17	8157	NUT, #6-32 KEPP NUT STAINLESS	2
20	15000WIRE	WIRING SUPPORT DOCUMENT	0
21	5912D2	FLAG TERMINAL	2
22	5943E3222	12GA RED WIRE	16"
23	8712ID-V21	VEND-2000 TIMER	1

REV		NO.		DESCRIPTION		DATE	BY
<p>THIS DOCUMENT SHALL NOT BE REPRODUCED NOR SHALL THE INFORMATION THEREIN BE USED BY OR DISCLOSED TO OTHERS EXCEPT AS AUTHORIZED BY J.E. ADAMS INDUSTRIES</p>							
<p>TITLE CONTROL PLATE ASSEMBLY</p>				<p>DATE 6/21/2003</p>		<p>BY Chadk</p>	
<p>UNREQUIRY TOLERANCES 1/16" - 3/32" 3/16" - .010" 3/8" - .005" AVAIL #118</p>				<p>SCALE 3/8" = 1"</p>		<p>DATE 6/21/2003</p>	
<p>DESIGNER Chadk</p>				<p>DATE 6/21/2003</p>		<p>REV 15001-10A</p>	
<p>APPROVED </p>				<p>DATE 6/21/2003</p>		<p>REV A</p>	



15001-5A

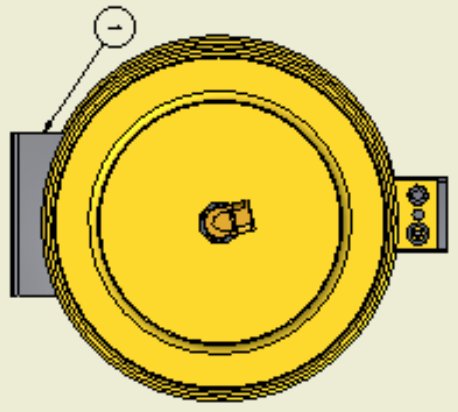
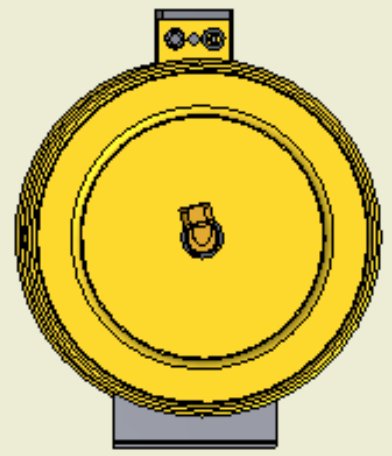
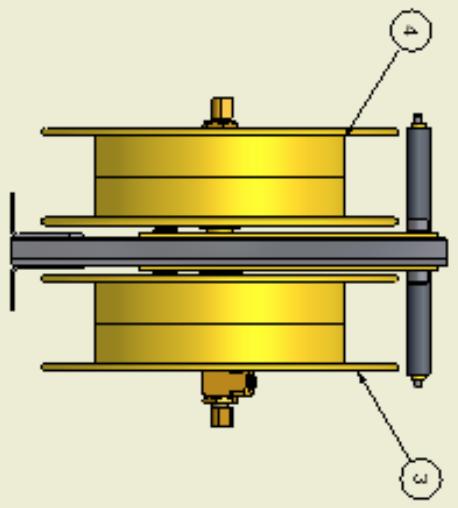
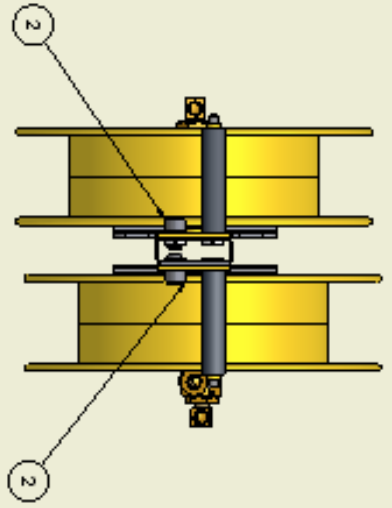

BILL OF MATERIALS			
ITEM	PAR_NUM	DESCRIPTION	QTY
1	15001-5W	REEL BAR WELDMENT-XMAX	1
2	581505	1/2" 13 x 5/8 HEX SOC HEAD SCREW	2
3	6225-7	RIGHT REEL	1
4	6025-8	REEL HOSE	1

A	2438	RIGHT REEL AND SCREW ASSEMBLY	5.00	2K
REV	00	DESCRIPTION	DATE	BY

THIS DOCUMENT IS NOT TO BE REPRODUCED OR TRANSMITTED IN ANY FORM OR BY ANY MEANS, ELECTRONIC OR MECHANICAL, INCLUDING PHOTOCOPYING, RECORDING, OR BY ANY INFORMATION STORAGE AND RETRIEVAL SYSTEM.

HOSE REEL ASSEMBLY

15001-5A	15001-5A	15001-5A
----------	----------	----------

BILL OF MATERIALS			
ITEM	PART NUM	DESCRIPTION	QTY
2	9855	3/4 HP THOMAS COMPRESSOR	1
3	5715B002	SCREW, 1/4-20 X 3/8 POWERLOCK	4
4	7122-RV1	RELIEF VALVE	1
5	15001-8W	COMPRESSOR BRACKET WELDMENT	1

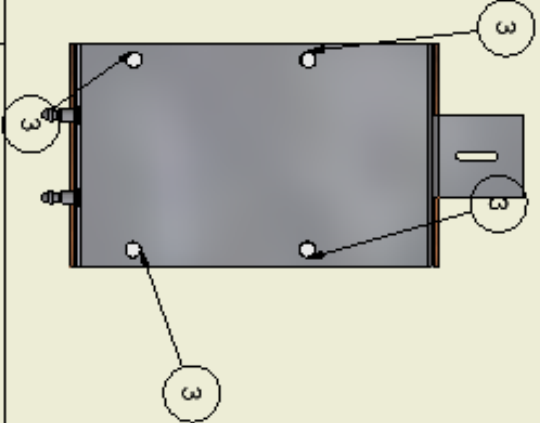
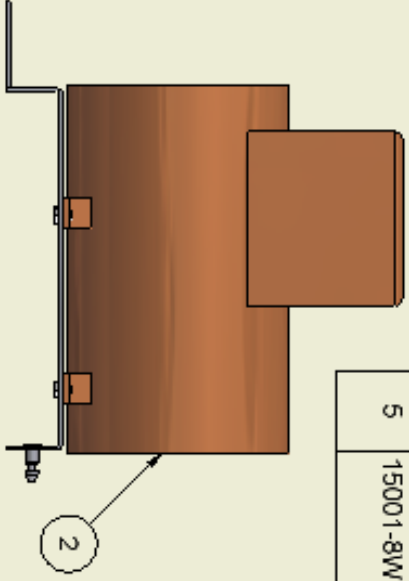
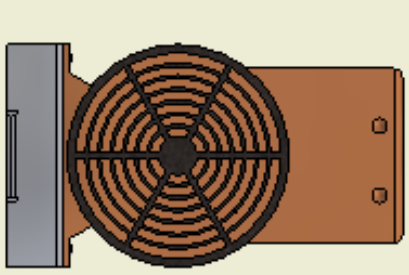

NOTE:
PART 4 NOT SHOWN IN DRAWING. ATTACH TO COMPRESSOR HEAD.

REV	NO.	DESCRIPTION	DATE	BY
THIS DOCUMENT SHALL NOT BE REPRODUCED NOR SHALL THE INFORMATION THEREIN BE USED IN ANY MANNER WITHOUT THE WRITTEN PERMISSION OF CHRYSLER GROUP LLC.				

UNSPECIFIED TOLERANCES		MATERIAL	
1 PL	-.030	SCALE	
2 PL	-.010	DATE	6/21/2003
3 PL	-.003	BY	Chadk
ANGLE 11.0°		PART	

THE COMPRESSOR/BRACKET ASSEMBLY

15001-8A

15000

BILL OF MATERIALS				BILL OF MATERIALS			
ITEM	PART NUM	DESCRIPTION	QTY	ITEM	PART NUM	DESCRIPTION	QTY
42	8545-2	HOSE	2	3	1500-12A	CONTROL PLATE ASSEMBLY	1
43	8597	5" 6 WASHER	1	4	1500-17	CONTROL PLATE COVER	1
44	8598	5" 6 LOCK WASHER	1	5	1500-18W	DOOR PANEL WELDMENT	1
44	882-7	WATER SPOUT	1	6	1500-1W	WRAP WELDMENT - XIMAX	1
59	1500C-150	PALLET X-MAX (30 x 20)	1	7	1500-32W	DIGME WELDMENT	1
63	1500C-151	POX X-MAX (30 x 20 x 50)	1	8	1500-38W	CUT OFF SWITCH PLATE W/6 DIMENT	1
67	5539D5	RUBBER GROMMET	3	9	1500-38	CUT OFF SWITCH BRACKET	2
62	1500C-150	PALLET	1	10	1500-12A	MIRCO SWITCH ASSEMBLY	1
63	1500C-151	POX	1	11	1500-47W	LOCKING ROD W/6 DIMENT	2
64	5503D5	0 SIA NUT Nylock NLI	4	12	1500-42A	SOLENOID BRACKET ASSEMBLY	1
65	8820-1T	AMERICAN 2000 LOCK	2	13	1500-57A	CCOUNTER ASSY	1
68	8773	IB7 BOX W/ L3 AND LOCK	1	14	1500-5A	HOSE REEL ASSEMBLY	1
				15	1500-65	LOOKING CLAMP	2
				16	1500-8A	COMPRESSOR BRACKET ASSEMBLY	1
				17	5205D3	DIWEL PIN	8
				18	5900D2	5" 6 - 8 x .75 CARR BOLT	1
				19	5901D4	1/4-20 x 3/4 HHCS-SS	1
				20	5903D5	1/4 SIA NC Nylock NUT	8
				22	5906D3	3/8 SAE WASHER	4
				23	5911D4	NUTL 5/16-18 UNC KEYP-SS	1
				24	5921D-	3/8 LOCK WASHER	4
				25	5922D3	3/8-18 x .75 HEX HEAD	4
				26	5936D4	1/4-20 UNC CARRIAGE ROLL	8
				28	5940D-	1/4 20 x 1/2 PHIL PAN HEAD SCREW	8
				29	5962D3	5-32 x 1/2 PHIL PAN -MACH HE SCREW	2
				30	5913D3	GREEN NEONLIGHT	1
				31	8227-1	RETAINER ROLLER	2
				32	6027-2	RETAINER ROLLER	4
				33	607-3	ROLLER HOSE GUIDE	8
				34	8281	CABLE MOUNT 3M BRAND ONLY	7
				35	8284	CABLE TIE	10
				36	8744A	ASSFMBLY COIN MECH	1
				37	8757	NUTL .06 32 KEPP NUT STAINLESS	16
				38	8533-411	GUAGE ASSY	1
				39	8533-7	HOSE ASSY	1

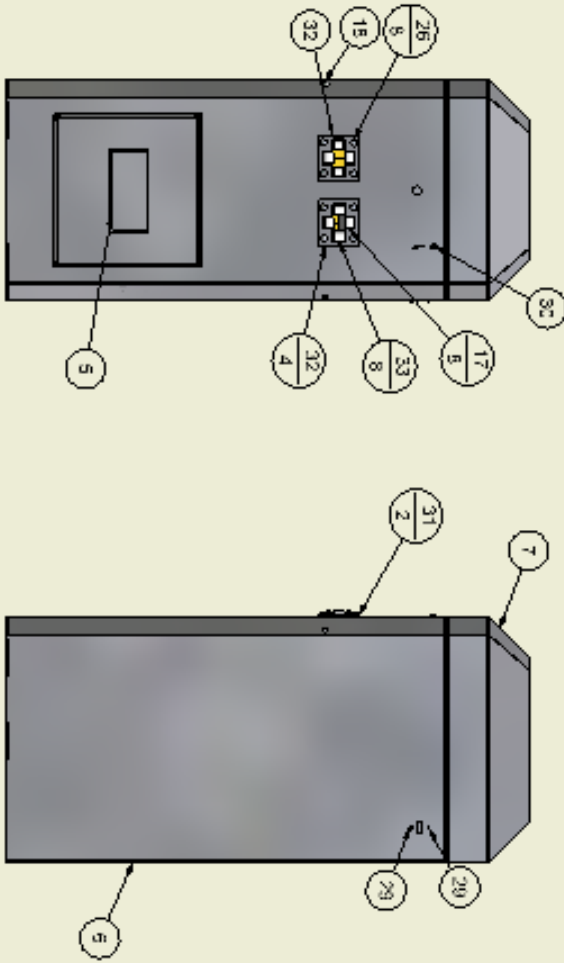

ITEM	PART NUM	DESCRIPTION	QTY
1	15000	AIR/WATER ASSEMBLY	1

REV	DESCRIPTION	DATE	BY
1	REMOVED 082C 7 4 AND 2923 N1 ADDED 21062C 17	4-28	CK
2	REMOVED 553D151 AND ADDED 553D2635	7-6-01	CK
3	DESCRIPTION		

REV	DESCRIPTION	DATE	BY
1	REMOVED 082C 7 4 AND 2923 N1 ADDED 21062C 17	4-28	CK
2	REMOVED 553D151 AND ADDED 553D2635	7-6-01	CK
3	DESCRIPTION		

AIR/WATER ASSEMBLY

 15000

ALL DIMENSIONS SHALL BE IN INCHES UNLESS OTHERWISE SPECIFIED.
 UNLESS OTHERWISE SPECIFIED, ALL DIMENSIONS SHALL BE TO CENTER UNLESS OTHERWISE SPECIFIED.

15000WIRE

THIS DOCUMENT SHALL NOT BE REPRODUCED NOR SHALL THE INFORMATION THEREIN BE USED BY OR DISCLOSED TO OTHERS EXCEPT AS AUTHORIZED BY J.E. AVONIS INDUSTRIES

BILL OF MATERIAL

ITEM NO.	PART NO.	DESCRIPTION	QTY.
----------	----------	-------------	------

NOTES:
 1) FIELD WIRING MUST CO-ORDINATE WITH LOCAL AND NATIONAL ELECTRICAL CODES

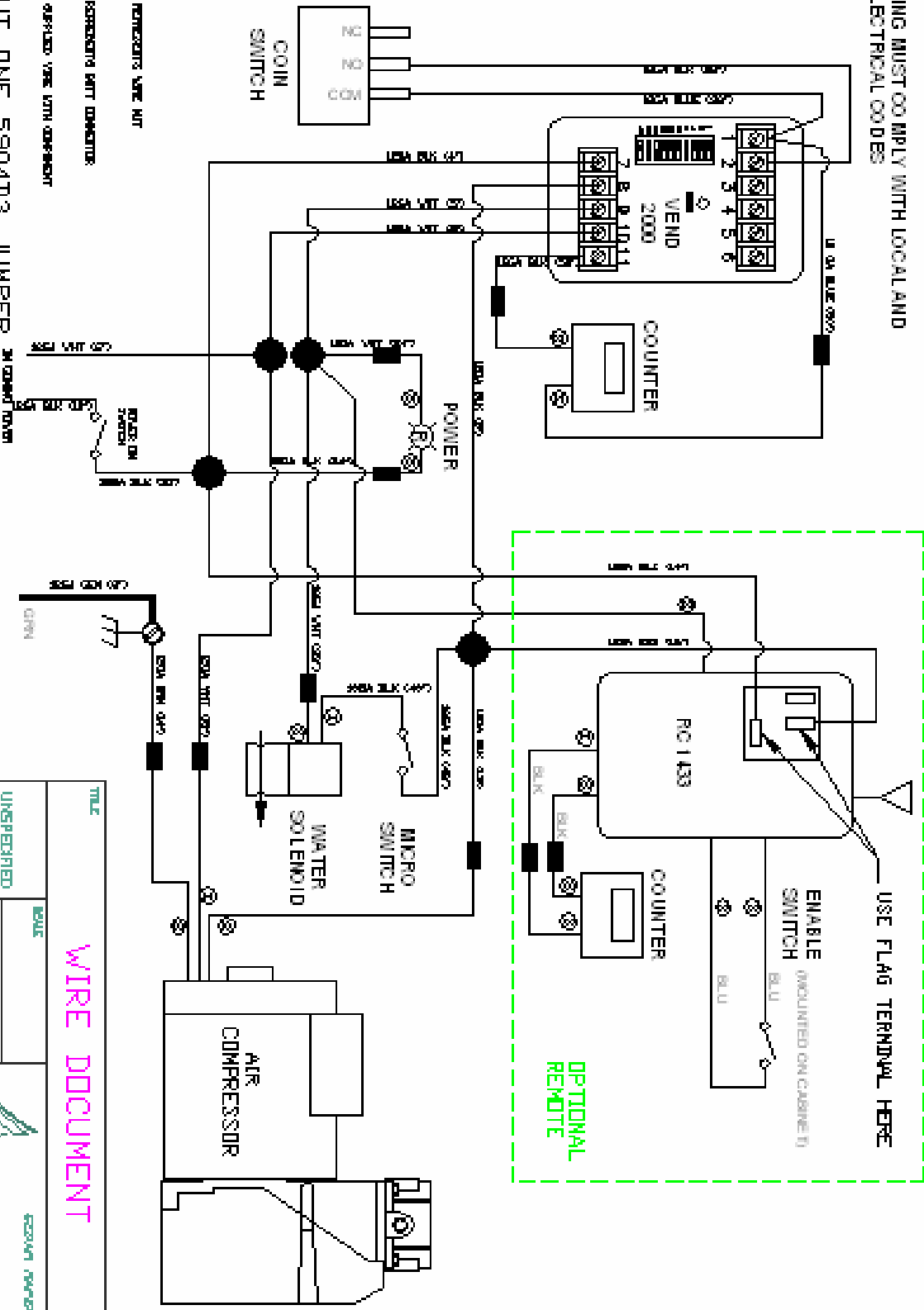

NOTE: PUT ONE 5904D3 JUMPER BETWEEN TERMINAL 9 & 10

- REMOVABLE WIRE NUT
- RESISTING SPLIT CONNECTOR
- ⊗ SERVICED WIRE WITH CONNECTOR

WIRE DOCUMENT

REV	NO.	DESCRIPTION	DATE	BY	UNSPECIFIED TOLERANCES	FRAC'T.	PL.	DATE	REV. NO.	REV. DATE	REV. NO.	REV. DATE
						41-32	2	9-03				
						41-32	3					
						41-10						
						11-07						

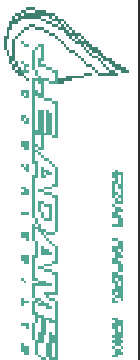

15000WIRE